

PRINTED COPY IS UNCONTROLLED

LOCK PIN

THIS IS A C.R.S. DETAIL THAT KEEPS A SLIDE ON AN ANGLE FROM SLIDING DOWN, SHOULD SLIDE RETURN MECHANISM FAIL WHEN SLIDE IS BEING REPAIRED IN DIE.

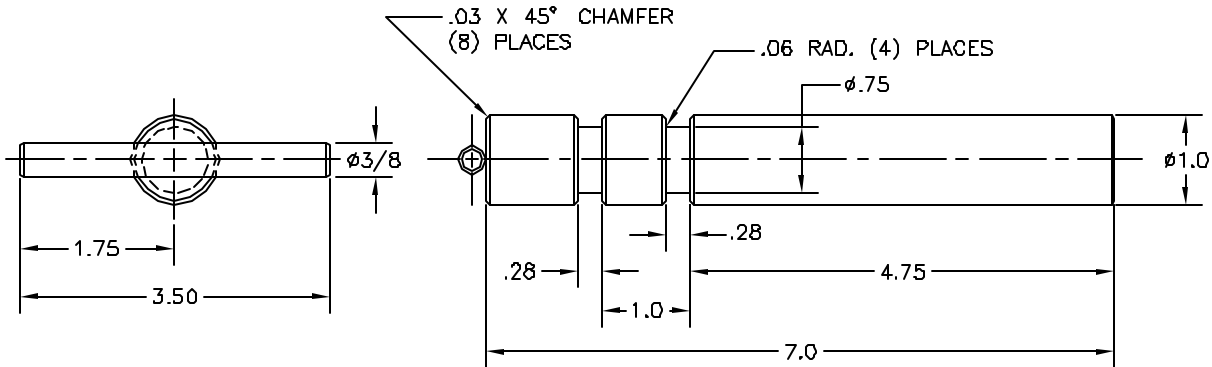

FOR RETAINER PLATE
SEE PAGE JF-5

JOLICO NO.	FORD REF. NO.
J-61903	DX7-6-0301

SLIDE STOP BLOCKS

THIS DETAIL STOPS A SLIDE AT ITS OPEN POSITION. REMOVAL OF THIS BLOCK DURING SLIDE, REPAIR WILL PERMIT ADDITION TRAVEL OF SLIDE, TO FACILITATE REPAIRS.

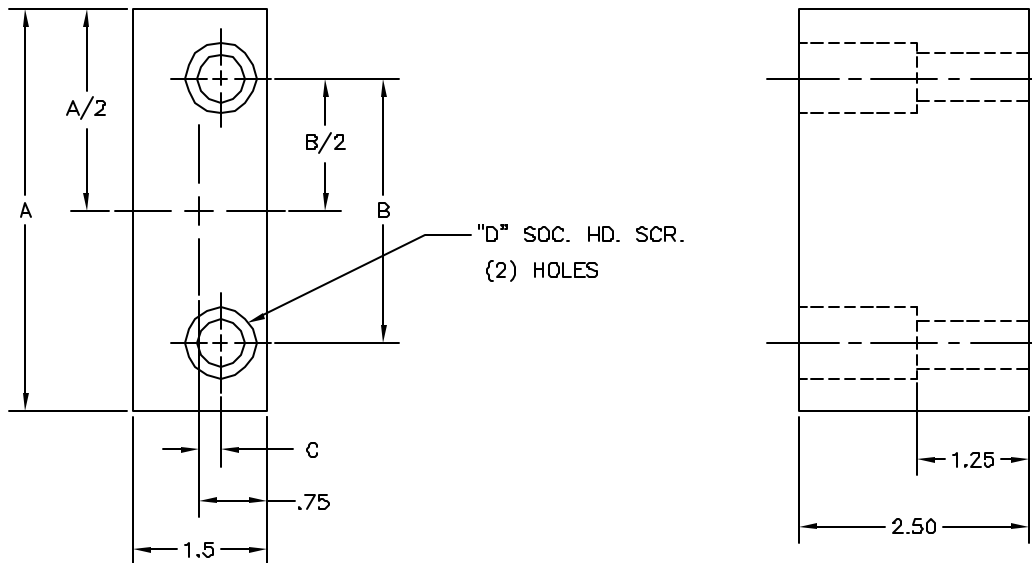

JOLICO NO.	FORD REF. NO.	A	B	C	D
J-28701	DX7-22-2001	4.5	3.00	.25	1/2
J-28221	DX7-22-2101	3.0	1.75	—	5/8